



Description – James M. Scott Family Trust
5.0 Acre Tract #1

2020-006303
Revised - July 20, 2020

A tract of land lying in the Southwest Quarter of the Northwest Quarter of Section 17, Township 63 North, Range 11 West, Knox County, Missouri and being more fully described as follows to-wit:

Beginning at a 5/8" iron pin marking the West Quarter Corner of said Section 17; thence North 01 degree, 24 minutes and 43 seconds East along the West line of said Section and along Knox County Route #42 (a.k.a. Discovery Avenue) 434.83 feet to a point from which a 5/8" iron pin bears South 89 degrees, 22 minutes and 51 seconds East 25.00 feet; thence South 89 degrees, 22 minutes and 51 seconds East leaving said West line and said County Route and parallel with the East-West centerline of said Section 500.17 feet to a 5/8" iron pin; thence South 00 degrees 56 minutes and 57 seconds West 434.80 feet to the East-West centerline of said Section, from which a 5/8" iron pin bears North 00 degrees, 56 minutes and 57 seconds East 25.00 feet; thence North 89 degrees, 22 minutes and 51 seconds West along said East-West centerline and along Knox County Route #59 (a.k.a. North Sever Road) 503.69 feet to the Point of Beginning, containing 5.0 Acres, more or less, with the above described being subject to that portion now being used for public road purposes and subject to other easements and rights-of-way of record or not of record, if any. As per survey #2020-006303 of Jason D. Janes, Missouri Professional Land Surveyor #2004017826 during July of 2020.

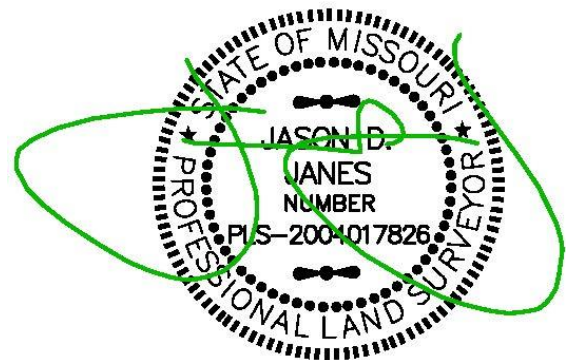

July 20, 2020

Prepared by
JANES SURVEYING, Inc.
222 South Main
Palmyra, Missouri 63461