



Description – James M. Scott Family Trust
162.7 Acre Tract #3 – Page 1 of 2

2020-006303
Revised - July 20, 2020

A tract of land lying in the South Half of the South Half of Section 8 & the North Half of the Northwest Quarter of Section 17, Township 63 North, Range 11 West, Knox County, Missouri and being more fully described as follows to-wit:

Beginning at a 5/8" iron pin marking the Corner common to Sections 7, 8, 17 & 18; thence South 89 degrees, 27 minutes and 57 seconds East along the line common to said Sections 8 & 17 a distance of 1339.10 feet to a 5/8" iron pin marking the Southwest Corner of the Southeast Quarter of the Southwest Quarter of said Section 8; thence North 00 degrees, 57 minutes and 42 seconds East leaving said common Section line and along the West line of said Quarter-Quarter Section 1329.77 feet to a 5/8" iron pin marking the Northwest Corner of said Quarter-Quarter Section; thence South 89 degrees, 32 minutes and 52 seconds East leaving said West line and along the North line of said Quarter-Quarter Section 1339.36 feet to a 5/8" iron pin marking the Northwest Corner of the Southwest Quarter of the Southeast Quarter of said Section; thence South 89 degrees, 20 minutes and 02 seconds East leaving said North line and along the North line of said Quarter-Quarter Section 1333.01 feet to a 5/8" iron pin marking the Northeast Corner of said Quarter-Quarter Section; thence South 00 degrees, 46 minutes and 05 seconds West leaving said North line and along the East line of said Quarter-Quarter Section 1335.23 feet to a 5/8" iron pin marking the Southeast Corner of said Quarter-Quarter Section; thence North 89 degrees, 10 minutes and 53 seconds West leaving said East line and along the line common to said Sections 8 & 17 a distance of 1337.75 feet to a 5/8" iron pin marking the Quarter Corner common to said Sections 8 & 17; thence South 01 degree, 12 minutes and 41 seconds West leaving said common Section line and along the North-South centerline of said Section 17 a distance of 1315.98 feet to a 5/8" iron pin marking the Southeast Corner of the North Half of the Northwest Quarter of said Section 17; thence North 89 degrees, 25 minutes and 24 seconds West leaving said North-South centerline and along the South line of said North Half 2682.79 feet to the Southwest Corner of said North Half, from which a 5/8" iron pin bears South 89 degrees, 25 minutes and 24 seconds East 25.00 feet;

Description – James M. Scott Family Trust
162.7 Acre Tract #3 – Page 2 of 2

2020-006303
Revised - July 20, 2020

thence North 01 degree, 24 minutes and 43 seconds East leaving said South line and along the West line of said Section 17 and along Knox County Route #42 (a.k.a. Discovery Avenue) 1314.05 feet to the Point of Beginning, containing 162.7 Acres, more or less, with the above described being subject to that portion now being used for public road purposes and subject to other easements and rights-of-way of record or not of record, if any. As per survey #2020-006303 of Jason D. Janes, Missouri Professional Land Surveyor #2004017826 during July of 2020.

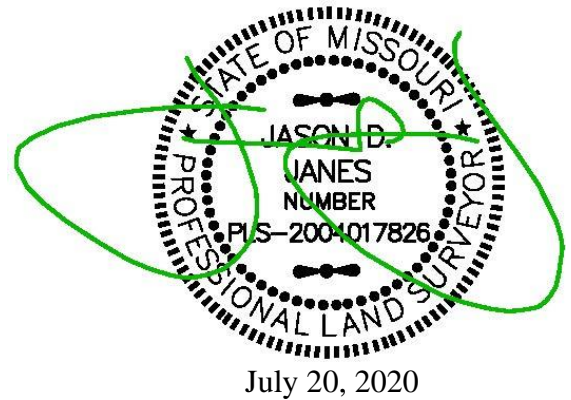

July 20, 2020

Prepared by
JANES SURVEYING, Inc.
222 South Main
Palmyra, Missouri 63461