



Description – James M. Scott Family Trust  
70.1 Acre Tract #4

2020-006303  
Revised – July 20, 2020

A tract of land lying in the West Half of the Southwest Quarter of Section 17, Township 63 North, Range 11 West, Knox County, Missouri and being more fully described as follows to-wit:

Beginning at a 5/8" iron pin marking the West Quarter Corner of said Section 17; thence South 89 degrees, 22 minutes and 51 seconds East along the East-West centerline of said Section and along Knox County Route #59 (a.k.a. North Sever Road) 1343.68 feet to a 5/8" iron pin marking the Northeast Corner of the West Half of the Southwest Quarter of said Section; thence South 01 degree, 18 minutes and 42 seconds West leaving said East-West centerline and said County Route and along the East line of said West Half and along Knox County Route #41 (a.k.a. North Sever Road) 2267.25 feet to a point from which a 5/8" iron pin bears North 89 degrees, 26 minutes and 16 seconds West 25.00 feet; thence North 89 degrees, 26 minutes and 16 seconds West leaving said East line and said County Route and parallel with the South line of said Section 1347.67 feet to a 5/8" iron pin on the West line of said Section; thence North 01 degree, 24 minutes and 43 seconds East along said West line 2268.64 feet to the Point of Beginning, containing 70.1 Acres, more or less, with the above described being subject to that portion now being used for public road purposes and subject to other easements and rights-of-way of record or not of record, if any. As per survey #2020-006303 of Jason D. Janes, Missouri Professional Land Surveyor #2004017826 during July of 2020.

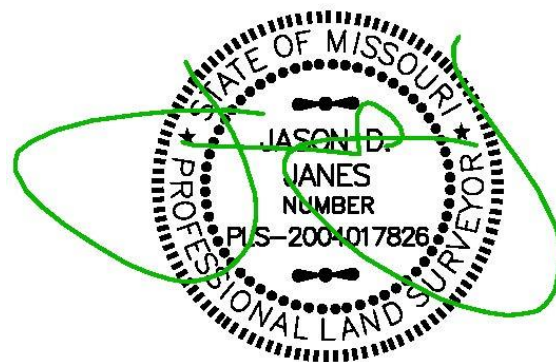

July 20, 2020

Prepared by  
**JANES SURVEYING, Inc.**  
222 South Main  
Palmyra, Missouri 63461